

Mammoth Road Closure – beginning Dec. 3, 2018

Beginning Monday, December 3, 2018 Mammoth Road (Phase I - between Rockingham Road and Hall Road) will be closed to thru traffic due to the sewer construction. Please follow detour signs.

NO THRU TRAFFIC.

Use Rte. 28 & Page Road

We apologize for any inconvenience and thank you for your cooperation. Any questions contact the Dept of Public Works at 432-1100 x193

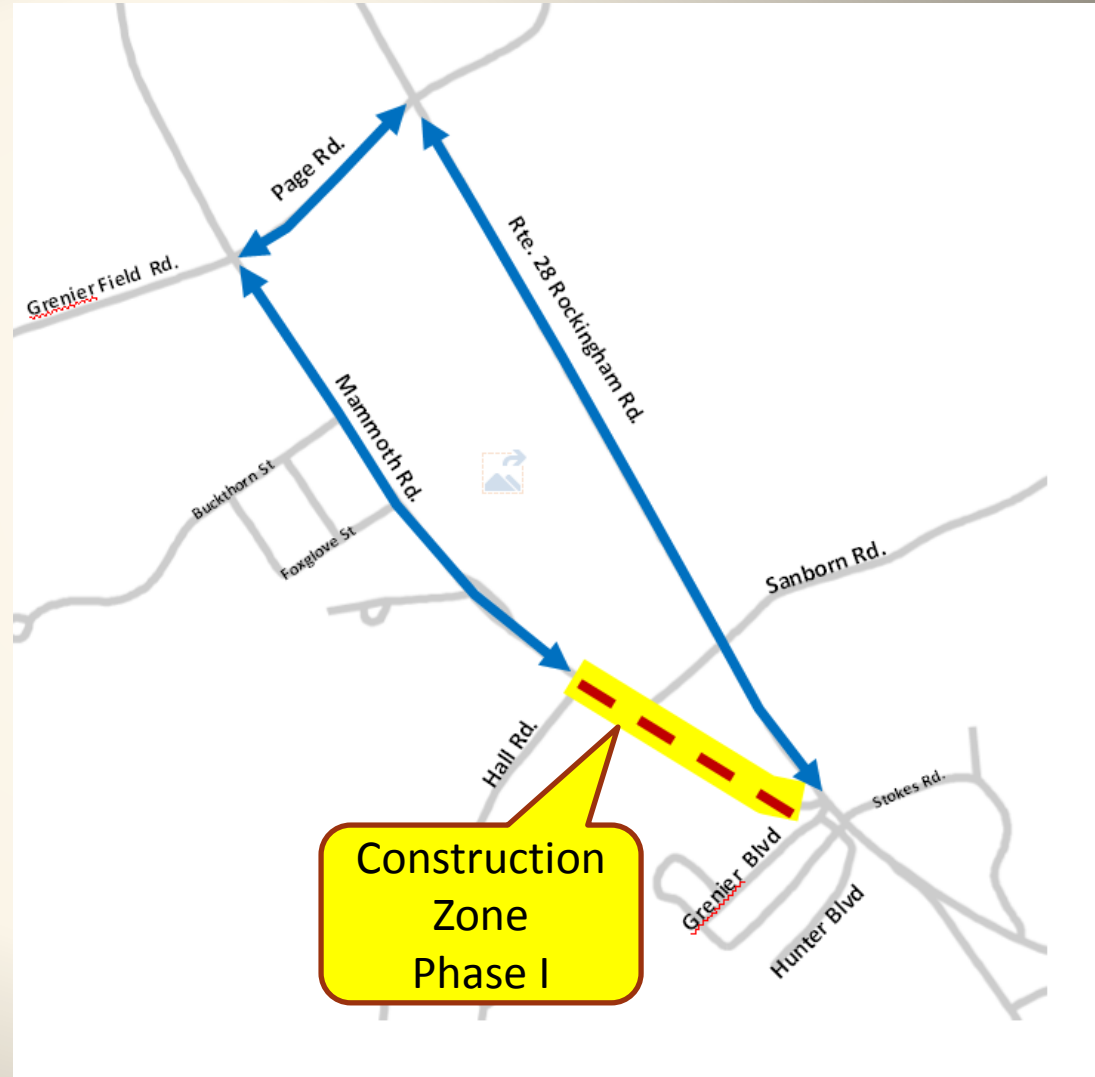

 Detour